



A floor plan diagram of a room. The room is divided into three main areas: 'Altan' (top left), 'Kamar' (bottom left), and 'Stova' (right). The walls are represented by thick grey lines. There are two doors: one in the top wall of the 'Altan' area, and one in the right wall of the 'Kamar' area. There are also two windows: one in the top wall of the 'Altan' area, and one in the bottom wall of the 'Kamar' area. The labels 'Altan', 'Kamar', and 'Stova' are written in black text within their respective areas.

Altan

Kamar

Stova

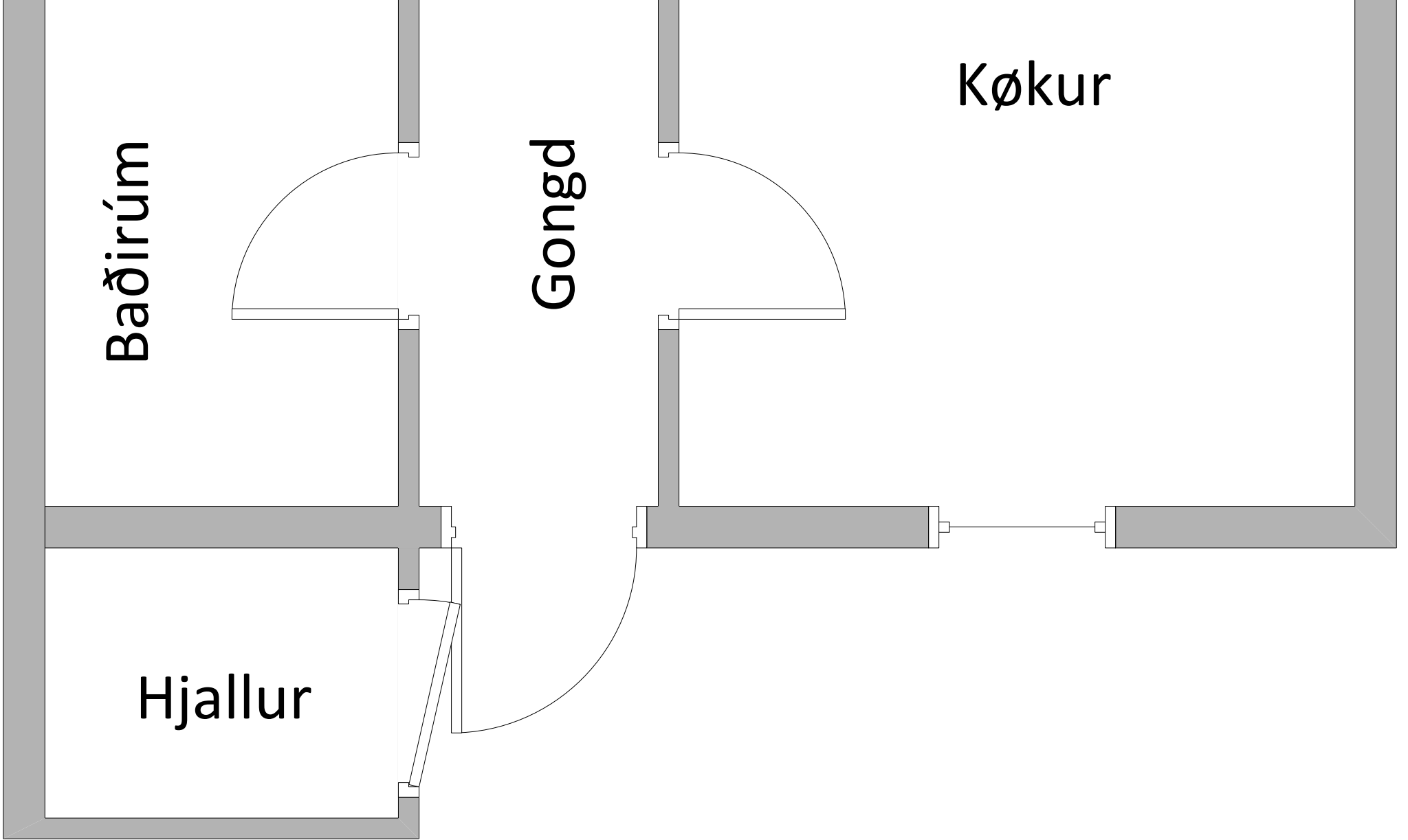

Tekningin er vegleiðandi

 **betri heim**